

What's in the Box

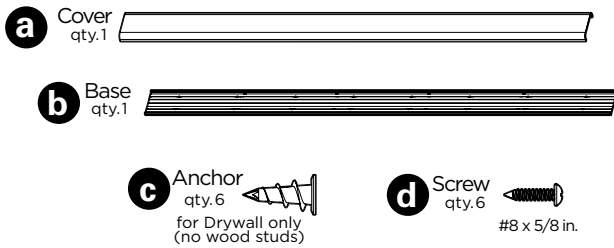

Grab your Tools

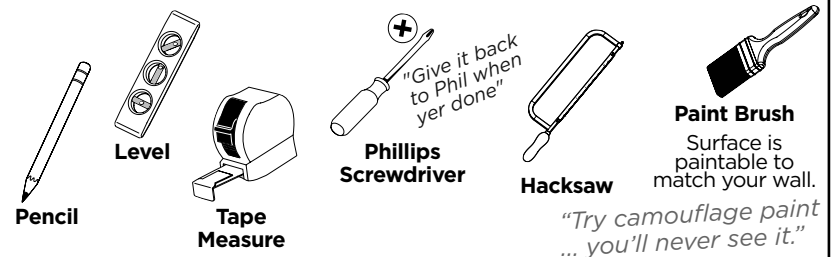

1. Measure Location

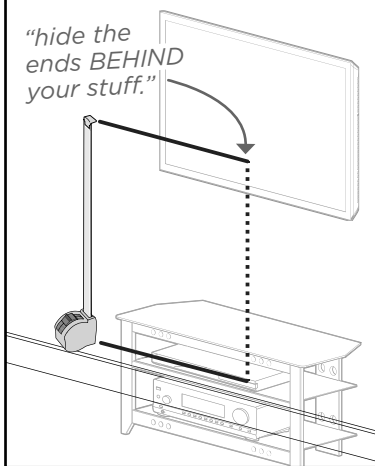

2. Cut to Length

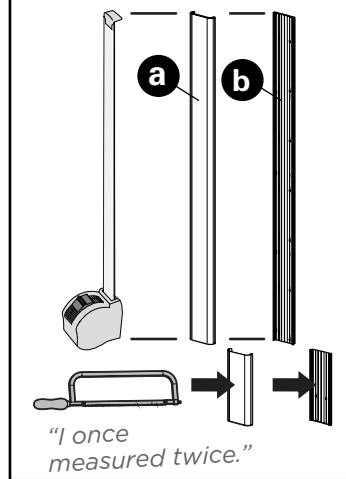

3. Position & Level

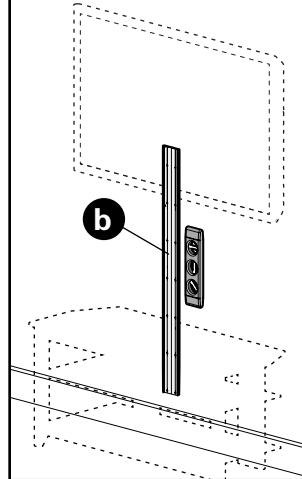

4. Mark 6 locations shown

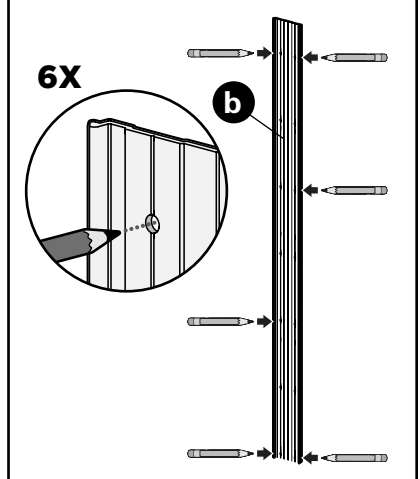

5. Secure Anchors

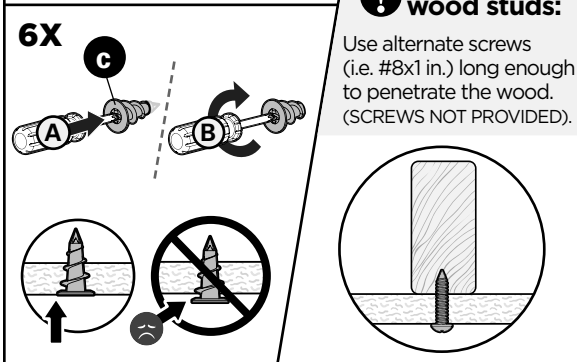

6. Install Base

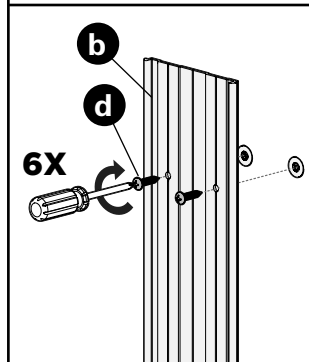

7. Route Cables

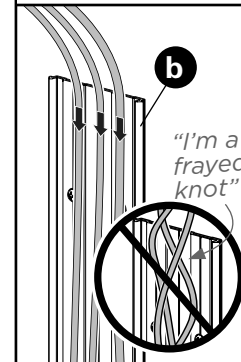

8. Attach Cover

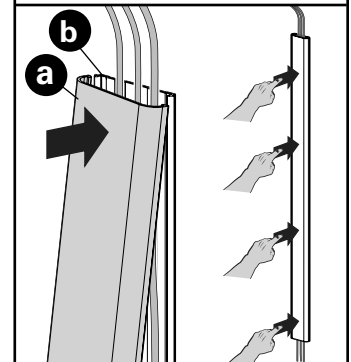

Confuzzled? Call the ECHOGEAR Pros:

1-855-428-2490

helpmehelpyou@ECHOGEAR.com

"Wanna show off your hard work?"

Share a picture of your completed project with **#YourGearUpgraded**.

Who knows, it might not be as bad as you thought"

COVER REMOVAL

Start by pulling the bottom edge away from the base.

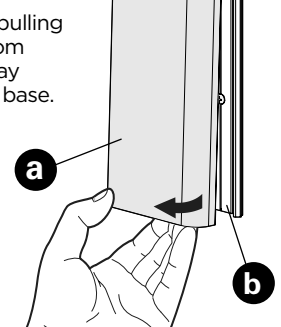

Milestone AV Technologies and its affiliated corporations and subsidiaries (collectively, "Milestone"), intend to make this manual accurate and complete. However, Milestone makes no claim that the information contained herein covers all details, conditions, or variations. Nor does it provide for every possible contingency in connection with the installation or use of this product. The information contained in this document is subject to change without notice or obligation of any kind. Milestone makes no representation of warranty, expressed or implied, regarding the information contained herein. Milestone assumes no responsibility for accuracy, completeness or sufficiency of the information contained in this document.

©2018 Milestone AV Technologies. All rights reserved. ECHOGEAR is a Milestone brand. ECHOGEAR and the ECHOGEAR logo are trademarks of Milestone.

Made in USA.
Milestone Global Headquarters • 6436 City West Parkway • Eden Prairie, MN 55344 USA