



#YourGearUpgraded

## SINGLE SHELF

Model **EGAV1**

INSTRUCTION MANUAL

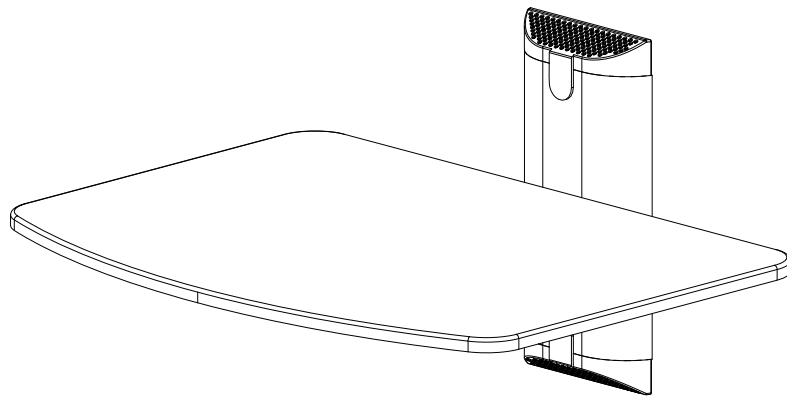

**IMPORTANT** SAFETY INSTRUCTIONS. **READ** ENTIRE MANUAL PRIOR TO USE. **SAVE** THESE INSTRUCTIONS

**YEA, THE BORING STUFF ... *but read it, so you don't jack things up!***

Please read through these instructions completely to be sure you're comfortable with this easy install process.

If you do not understand these instructions or have doubts about the safety of the installation, assembly or use of this product, contact Customer Service at 1-855-428-2490.

**⚠ CAUTION: Avoid potential personal injuries and property damage!**

- ▶ Do not allow children to climb or hang on shelf.
- ▶ Do not place a TV on the shelf.
- ▶ Do not place objects heavier the 15 lbs (6.8 kg) on the shelf.
- ▶ Use this mounting system only for its intended use as described in these instructions.
- ▶ Manufacturer is not responsible for damage or injury caused by incorrect assembly or use.

*"you keep your butt off it too!"*

## WEIGHT RESTRICTIONS

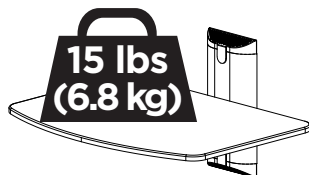

**DO NOT EXCEED 15 lbs. (6.8 kg)** for this shelf.

*"You can think about it ... but doooon't do it."*

# GRAB YOUR TOOLS

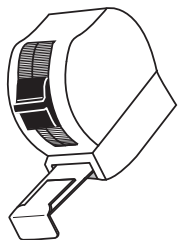

**Tape Measure**

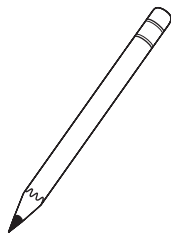

**Pencil**

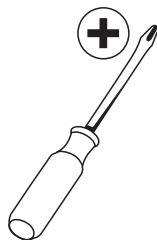

**Phillips Screwdriver**

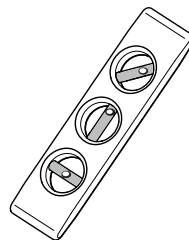

**Level**

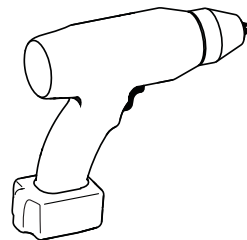

**Electric Drill**

*"We won't tell Phil you 🧐 borrowed 🧐 it."*

## Wood Stud Install

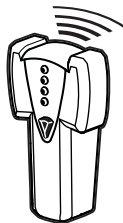

**Stud Finder**



**Awl**

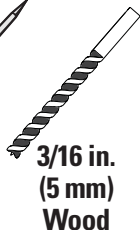

**Drill Bit**

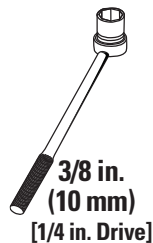

**Socket Wrench**

## Concrete Install

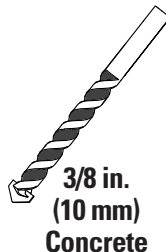

**Drill Bit**



**Hammer**

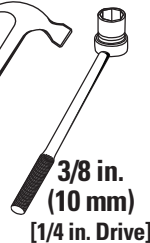

**Socket Wrench**

## Drywall Install



**Drill Bit**



**Hammer**

# WHAT'S IN THE BOX

**⚠ WARNING:** DON'T FEED TO CHILDREN — This product contains small items that could be a choking hazard if swallowed. Before starting assembly, verify all parts are included and undamaged. If any parts are missing or damaged, do not return the damaged item to your dealer; contact Customer Service. Never use damaged parts!

## STUFF FOR STEP 1

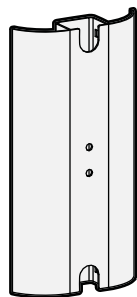

**Wall Plate**

**01** x 1

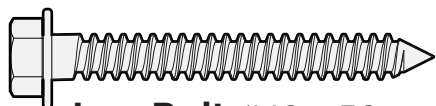

**Lag Bolt** (M6 x 50 mm)

**02** x 2

### For Drywall installations ONLY

**⚠ CAUTION:** Do not use in concrete or wood



**Drywall Screw** (#8 x 2 in.)

**03** x 2

**Drywall  
Anchors**

**04** x 2

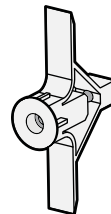

### For Concrete installations ONLY

**⚠ CAUTION:** Do not use in drywall or wood

**05** x 2

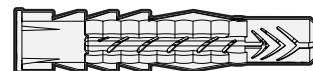

**Concrete Anchors**

 **NOTE:** Not all hardware included in this kit will be used.

## STUFF FOR STEP 2



**End Caps**  
(Wall Plate)

**06** x 2

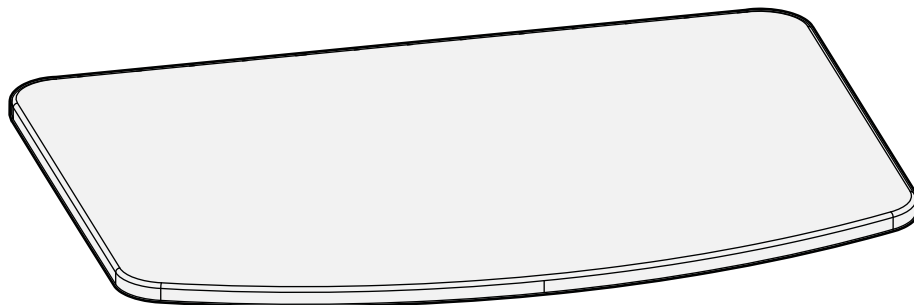

**Shelf**  
**07** x 1

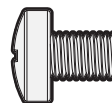

**M6x12 mm**

**08** x 2

**You're ready! LET'S DO THIS!**

## STEP 1A (FOR WOOD STUD)

## INSTALL THE WALL PLATE

### STEP 1A.1 Find a Stud

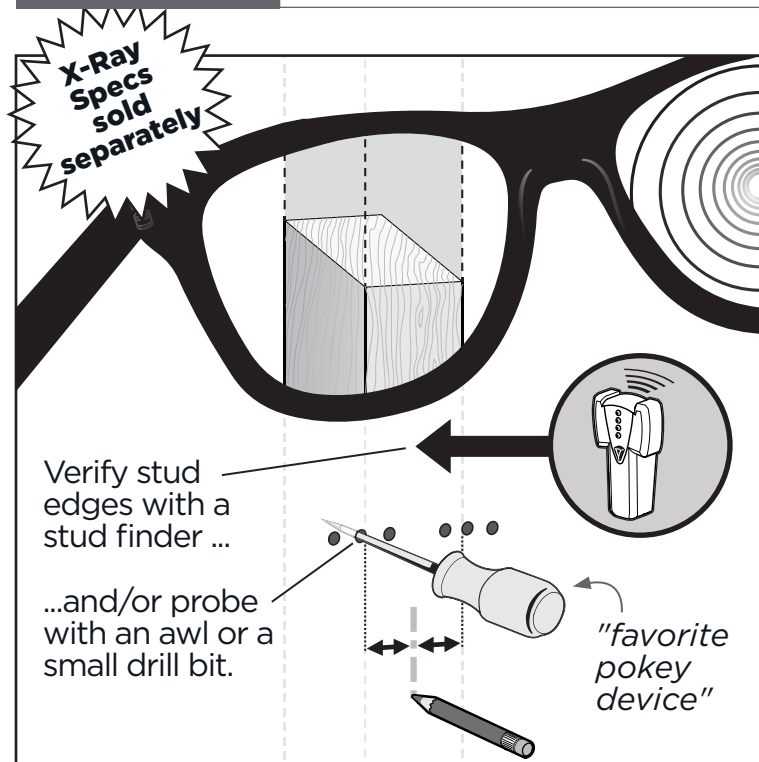

### STEP 1A.2 Mark Holes

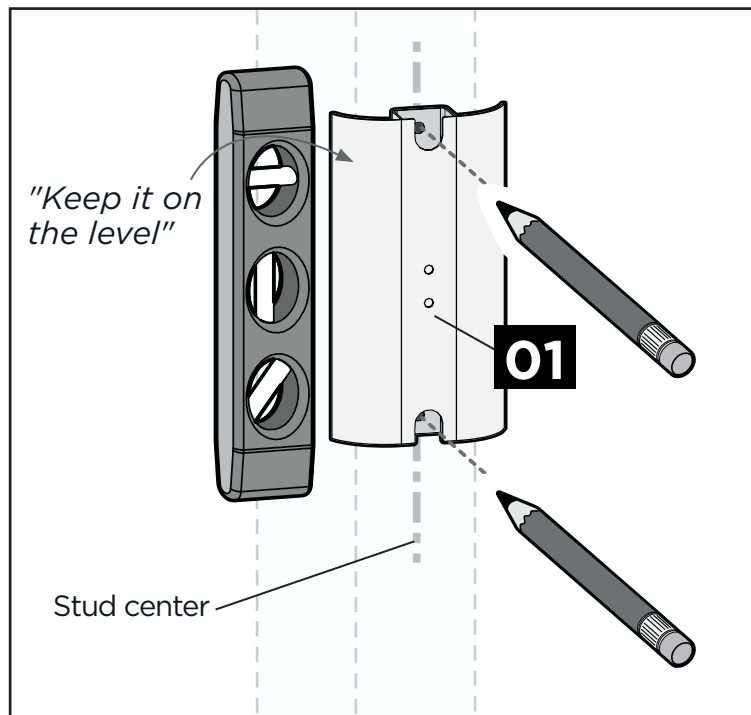

## Drill Holes

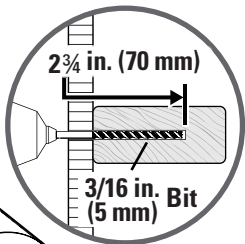

## STEP 1A.4 Secure Wall Plate

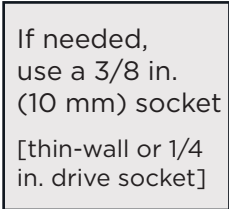

## STEP 1B (FOR DRYWALL)

### STEP 1B.1 Mark Holes

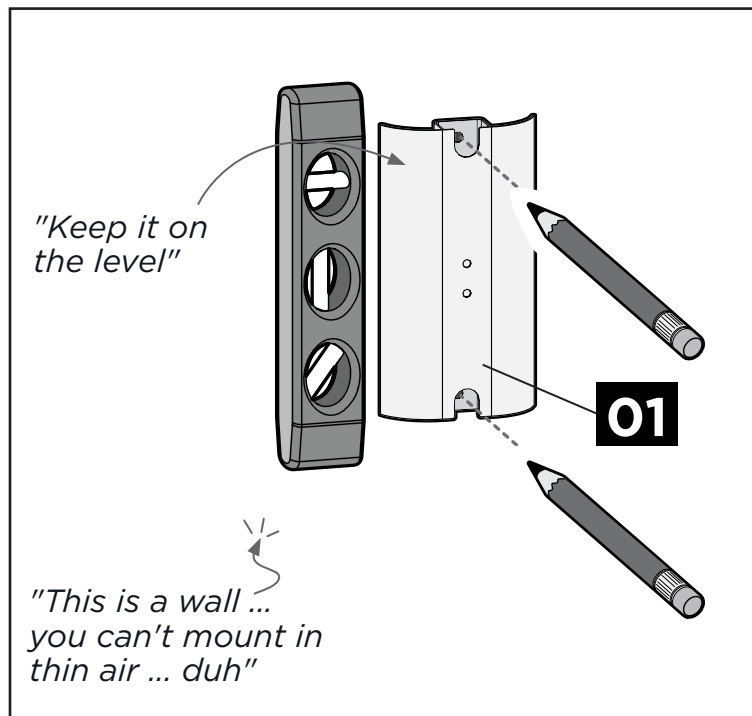

## INSTALL THE WALL PLATE

### STEP 1B.2 Drill Holes

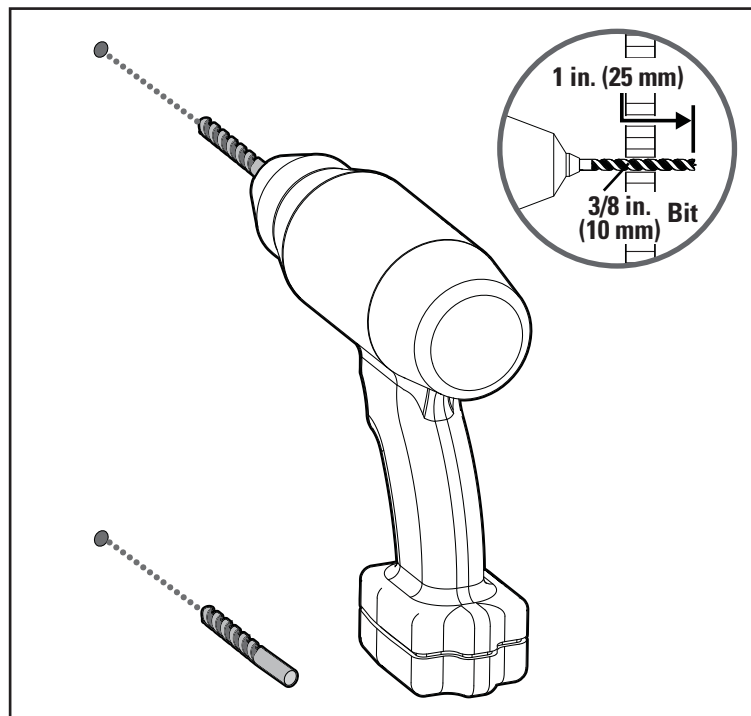



## STEP 1B.3 Insert Anchors

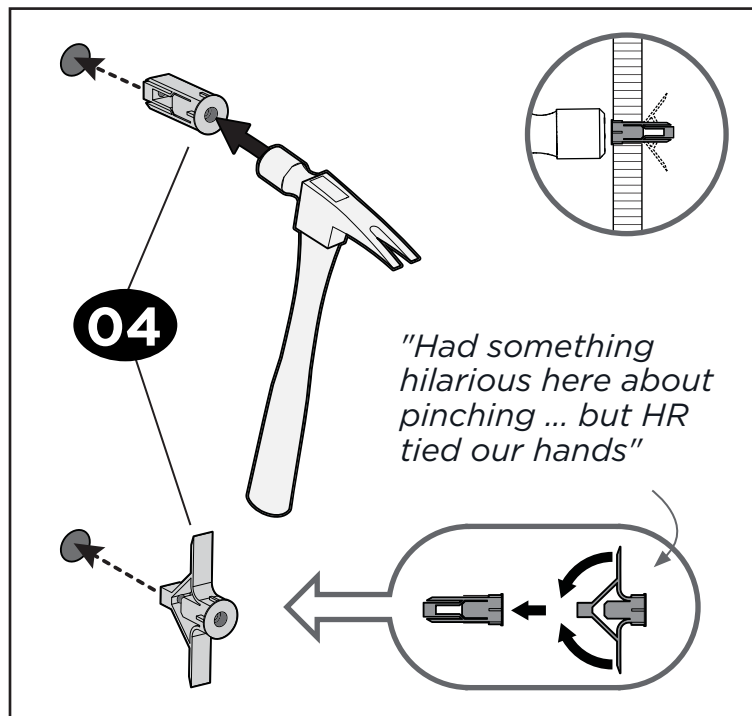

## STEP 1B.4 Secure Wall Plate

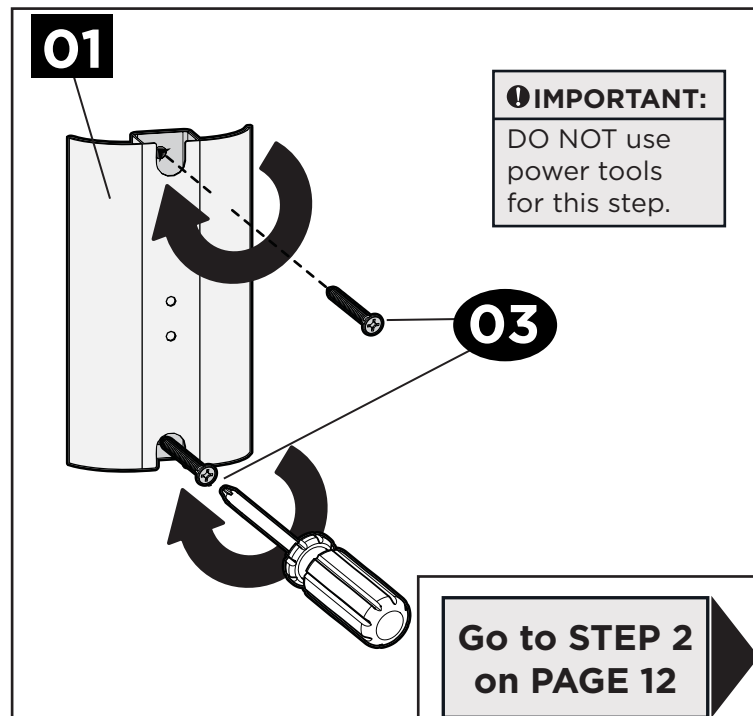

## STEP 1C (FOR CONCRETE)

### STEP 1C.1 Mark Holes

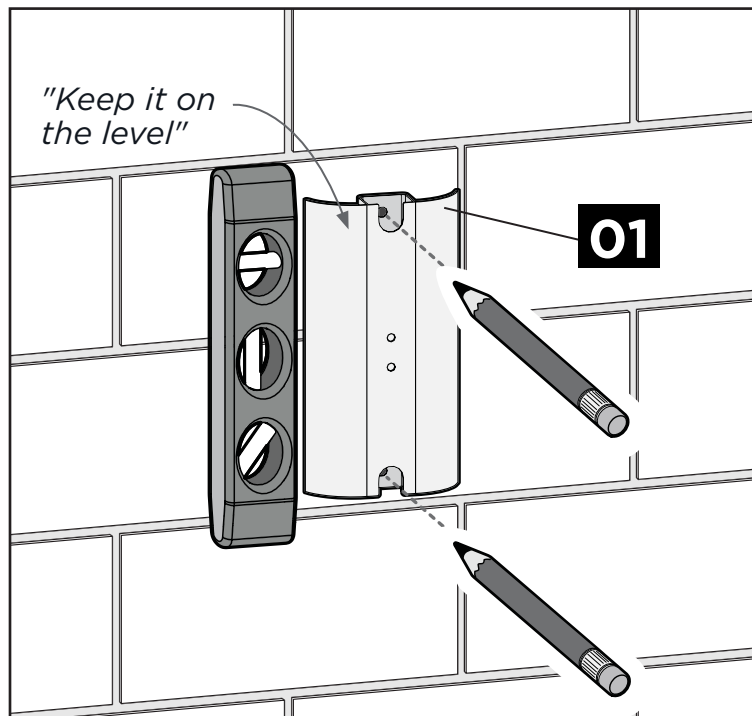

## INSTALL THE WALL PLATE

### STEP 1C.2 Drill Holes

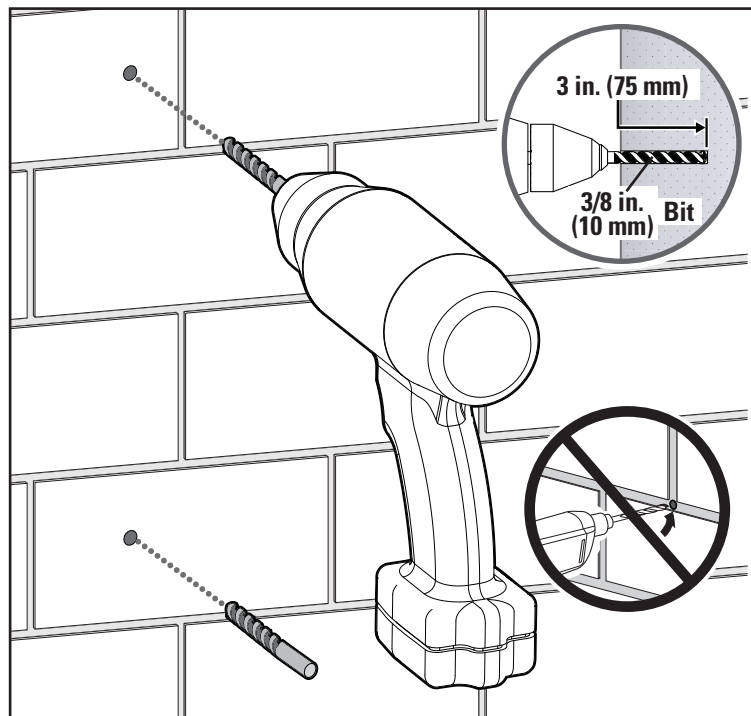

## STEP 1C.3 Insert Anchors

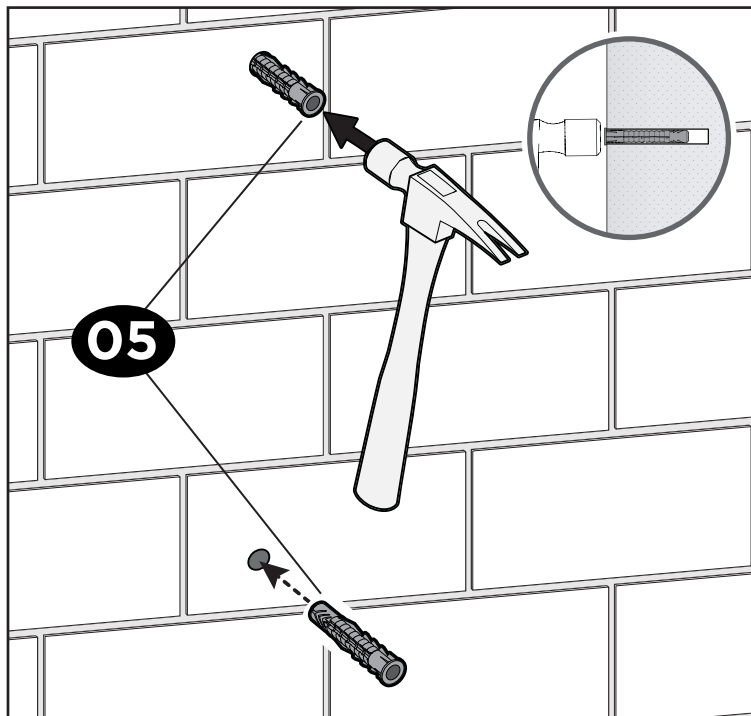

## STEP 1C.4 Secure Wall Plate

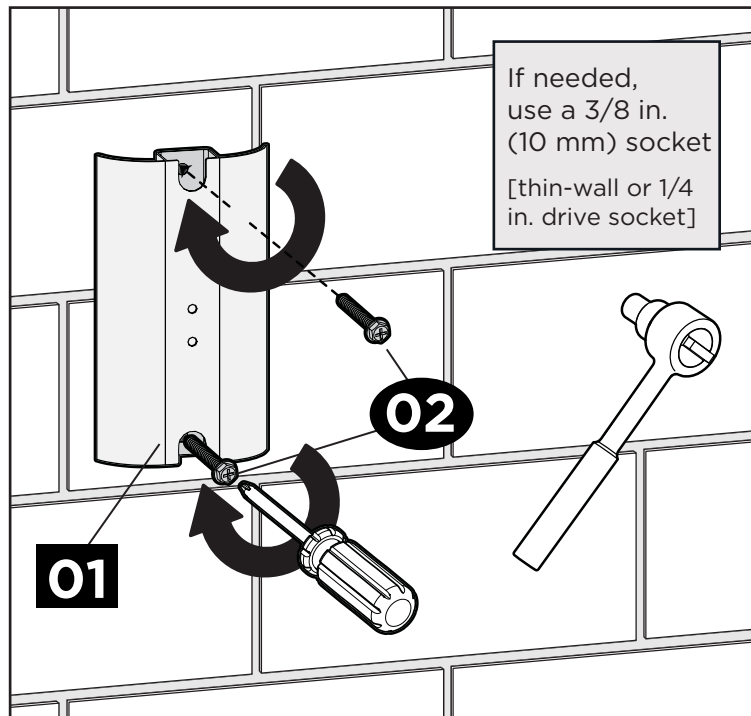

## STEP 2

## ATTACH SHELF TO WALL PLATE

### STEP 2.1 Insert End Caps

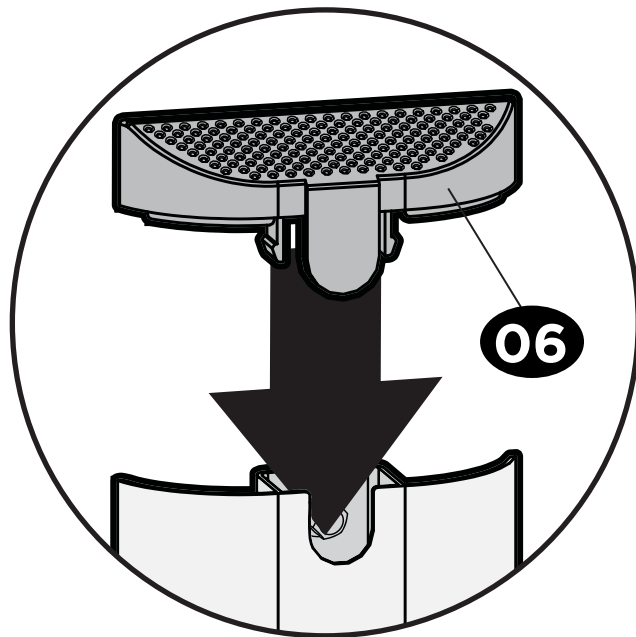
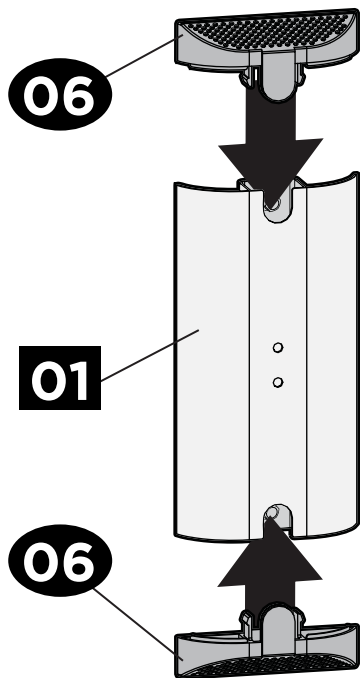

## STEP 2.2 Attach Shelf

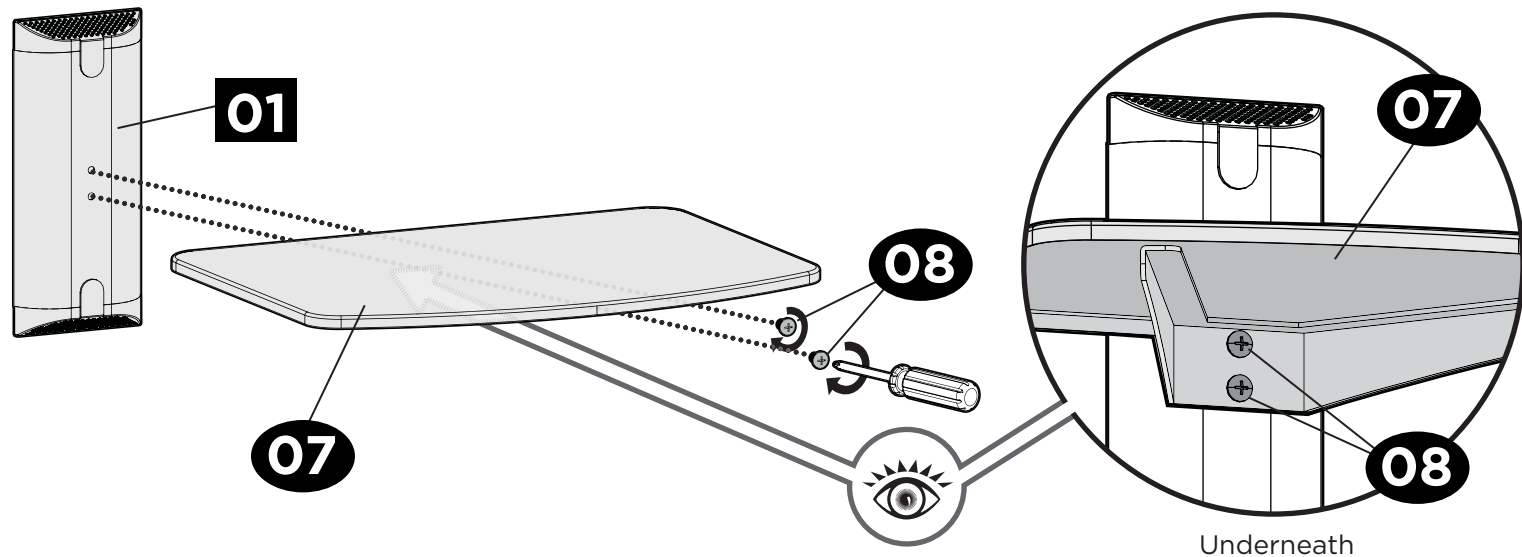



Milestone AV Technologies and its affiliated corporations and subsidiaries (collectively, “Milestone”), intend to make this manual accurate and complete. However, Milestone makes no claim that the information contained herein covers all details, conditions, or variations. Nor does it provide for every possible contingency in connection with the installation or use of this product. The information contained in this document is subject to change without notice or obligation of any kind. Milestone makes no representation of warranty, expressed or implied, regarding the information contained herein. Milestone assumes no responsibility for accuracy, completeness or sufficiency of the information contained in this document.

©2016 Milestone AV Technologies. All rights reserved. ECHOGEAR is a Milestone brand. ECHOGEAR and the ECHOGEAR logo are trademarks of Milestone.

Made in China.



***Confuzzled?* Call the ECHOGEAR Team:**



1-855-428-2490



helpmehelpyou@ECHOGEAR.com

“Wanna show off your hard work? Share a picture of your completed project with **#YourGearUpgraded**.

Who knows, it might not be as bad as you thought”