

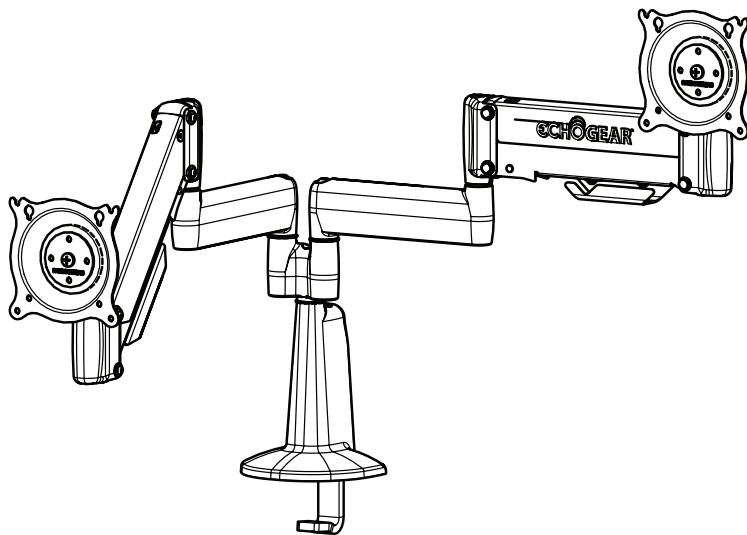

#YourGearUpgraded



DUEL SCREEN
MONITOR MOUNT FOR GAMING
INSTRUCTION MANUAL

Model **ECHO-GM2FC**

IMPORTANT SAFETY INSTRUCTIONS. **READ** ENTIRE MANUAL PRIOR TO QUEST. **SAVE** THESE INSTRUCTIONS.

BEFORE YOU EMBARK ON YOUR QUEST... *just read it so you don't get pwned!*

"Hopefully you are unscathed after detonating the mount from the packaging!..."

Please read through these instructions completely and check your monitors' owner manual to see if there are any special requirements for mounting your monitor.

If you do not understand these instructions, are a noob or have doubts about the safety of the installation, assembly or use of this product, contact:
The Echogear Pros @ 1-855-428-2490 or www.echogear.com.

⚠ CAUTION: Manufacturer is not responsible for damage or injury caused by incorrect assembly or use. To avoid potential personal injuries, property damage and tipping:

- ▶ Your mounting surface must be stable and rugged enough to support the weight and motion of the monitor and mount.
- ▶ Do not use this product for any purpose not explicitly specified by manufacturer.

WEIGHT RESTRICTIONS
Each monitor (including accessories)
CANNOT EXCEED:



*"You even lift, Brah?....
Ok, even if you do... doooooon't do it."*



SIZE UP YOUR MOUNTING SURFACE

**DESKTOP
THICKNESS**



0.8 in. - 2.6 in.
(20 mm - 66 mm)



**UUUUHHH?!?
Unsure?**

**Contact The Echogear Pros:
1-855-428-2490
www.echogear.com**



POWER UP! GRAB THESE TOOLS FROM YOUR ARSENAL

Required to Get the Job Done

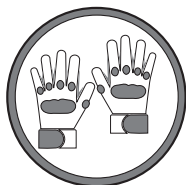

Yo Hands

*"No
snapin
pics for
twitter
til your
done!"*



**Phillips
Screwdriver**

*"Phil is
the boss!"*



BONUS LOOT!

3 FREE Inside Every Box

Hex Keys

$\frac{3}{16}$

A

$\frac{5}{32}$

B

$\frac{3}{32}$

C



*"A.K.A
Allen Wrench"*

Optional Based on Skill Level



Refreshment

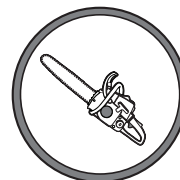

Saw



Pump



BFG

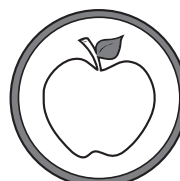

Apple

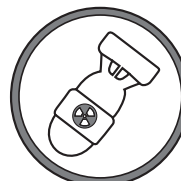

Mini-Nuke

We're driven to give DIYers an awesome install experience. We stand behind everything we make because you deserve the best entertainment experience without sacrificing quality and spending your whole paycheck.

Guess what? We'll help you through the entire process, too.

Why? Because we like to help and it's our passion to provide authentic service. We won't leave you hanging, no matter what.

Our U.S. based Echogear Pros answer the phone in all days ending in Y. That means availability to try and stump our expert staff 7 days a week.

Call us if you...

- ➊ Have any questions before, during, or after install.
- ➋ Need different hardware to fit your monitor model.
- ➌ Just need someone to chat with. We're here for you.

HERE'S YOUR LOADOUT

! WARNINGS: DON'T ALLOW CHILDREN TO FEED ON CONTENTS AND NEVER USE DAMAGED GOODS!



- ▶ This product contains small items that are a choking hazard if swallowed.
- ▶ Before you start assembly, verify all parts are included and undamaged. If any parts are missing or damaged, do not return the damaged item to your dealer; contact Customer Service.



GEAR FOR LEVEL 1

**1 Duel Arm
Desk Clamp**



1

5 Bumpers



2

**2 Clamp Screw
5/16-18 x 4 in.**



3

**2 Full Motion
Desk Mount
Arms**

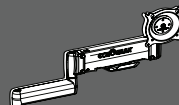

4

2 Pivot Pins



5

**2 Nuts
5/16-18**

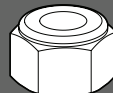

6

**2 Bearing
Spacers
(plastic)**



7

**6 Washers
(4 metal 2 plastic)**



8

9

GEAR FOR LEVEL 2

8 Screws
M4 X 12mm

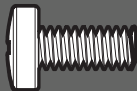

10

8 Screws
M4 X 30mm

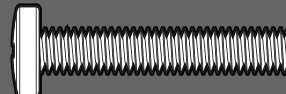

11

8 Spacers
5mm



12

8 Spacers
22mm

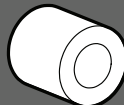

13

GEAR FOR LEVEL 3

2 Cable
Covers

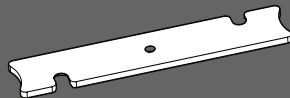

14

4 Screws
8-32x 3/8 in



15

LEVEL 1 LOCK N' LOAD! ASSEMBLE MOUNT AND CLAMP TO DESK

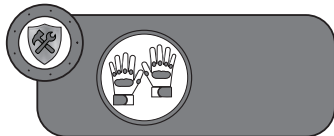
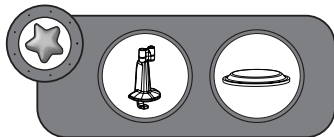

STAGE 1: Plaster Soft Bumpers⁺⁵ on Desk Clamp

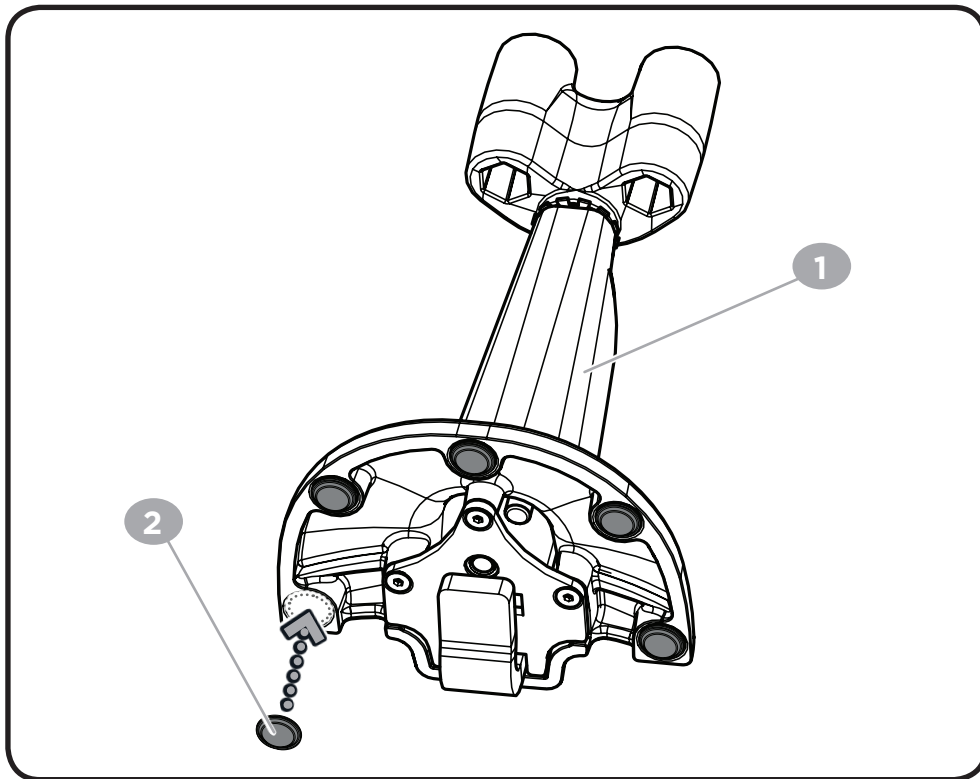



STAGE 2: Loosen Screw To Lower Clamp

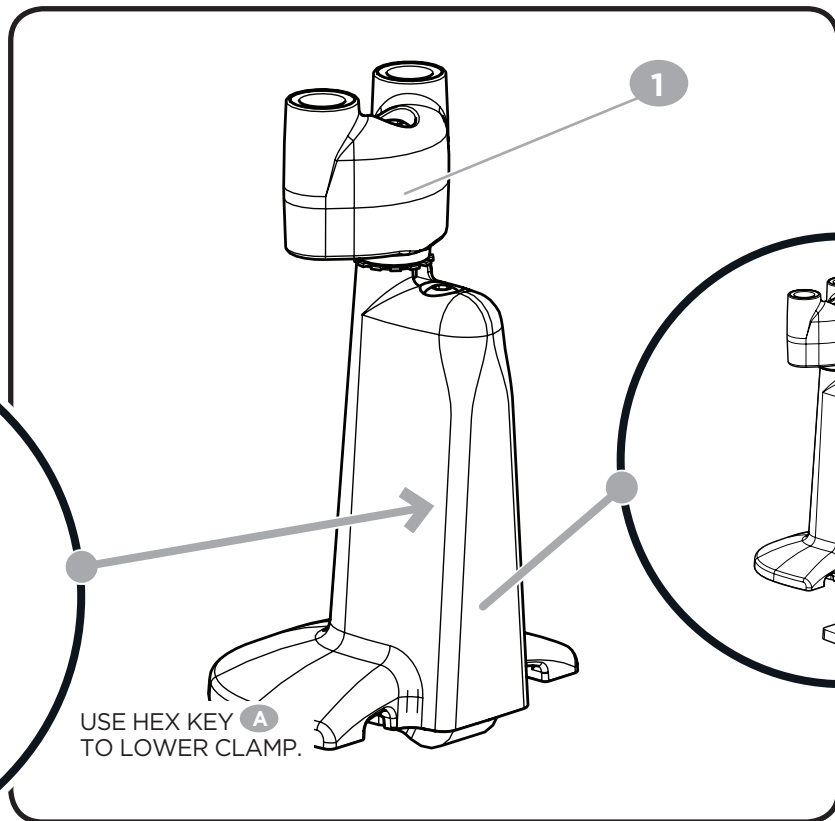
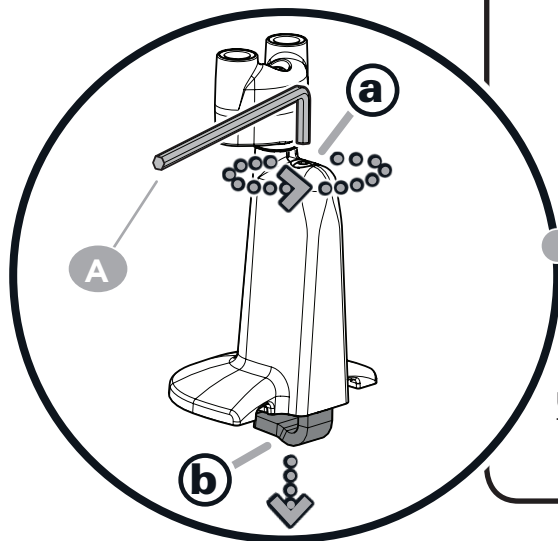
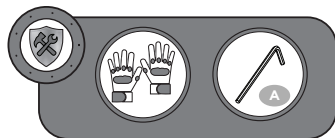
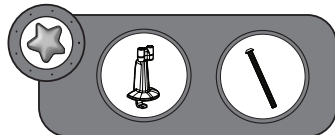

USE HEX KEY **A**
TO LOWER CLAMP.



STAGE 3: Tighten Screw To Attach Clamp to Desk

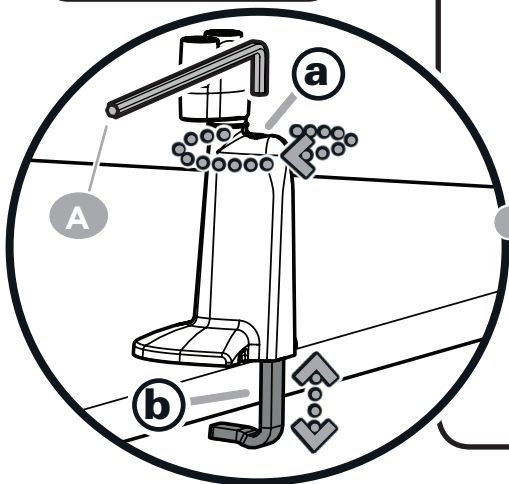
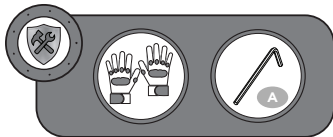
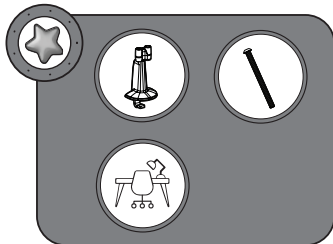

USE HEX KEY **A**
TO SECURELY
CLAMP IT DOWN.

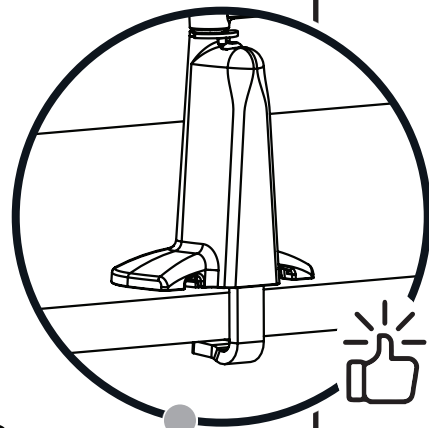
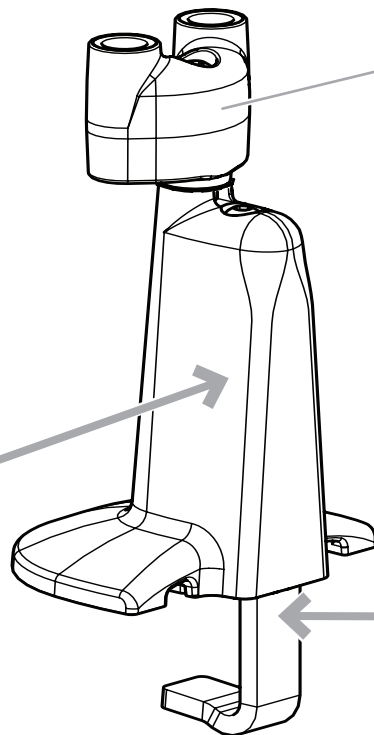

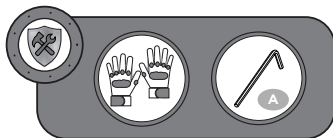
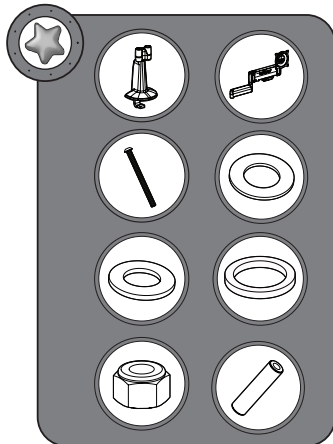

STAGE 4: Attach Both Arms to Mount

USE HEX KEY **A**
TO TIGHTEN.

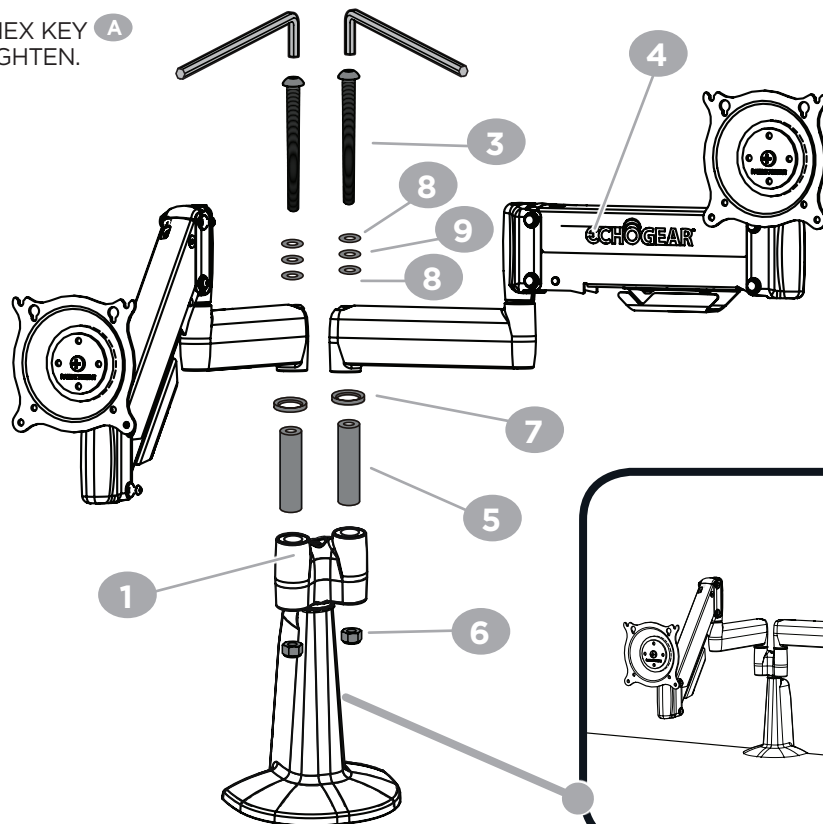

NOTE: ALL PARTS ARE THE
SAME FOR BOTH SIDES.

LEVEL 2 MAKE THE DROP! ATTACH MONITOR TO MOUNT

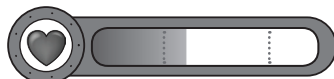

STAGE 1: Determine Screw Length and Spacer Size

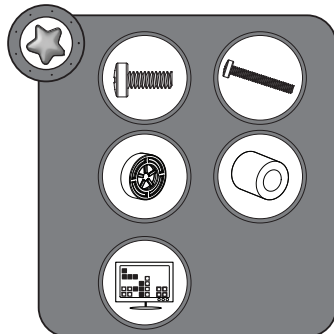

Select
Spacers
(if needed)

NOT NEEDED

Flat Monitor

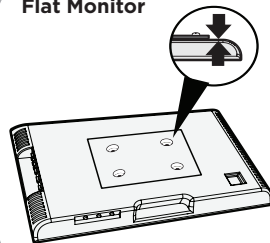

or

NEEDED FOR

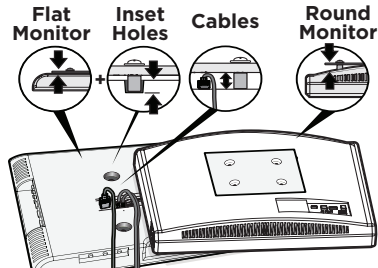

Select
Screws

Short Screw

9



or

Long Screw

10

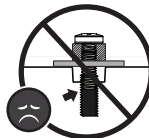

STAGE 2: Partially Insert Top Screws into Monitor

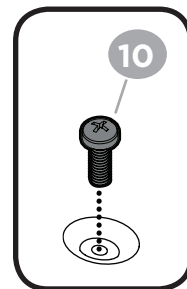
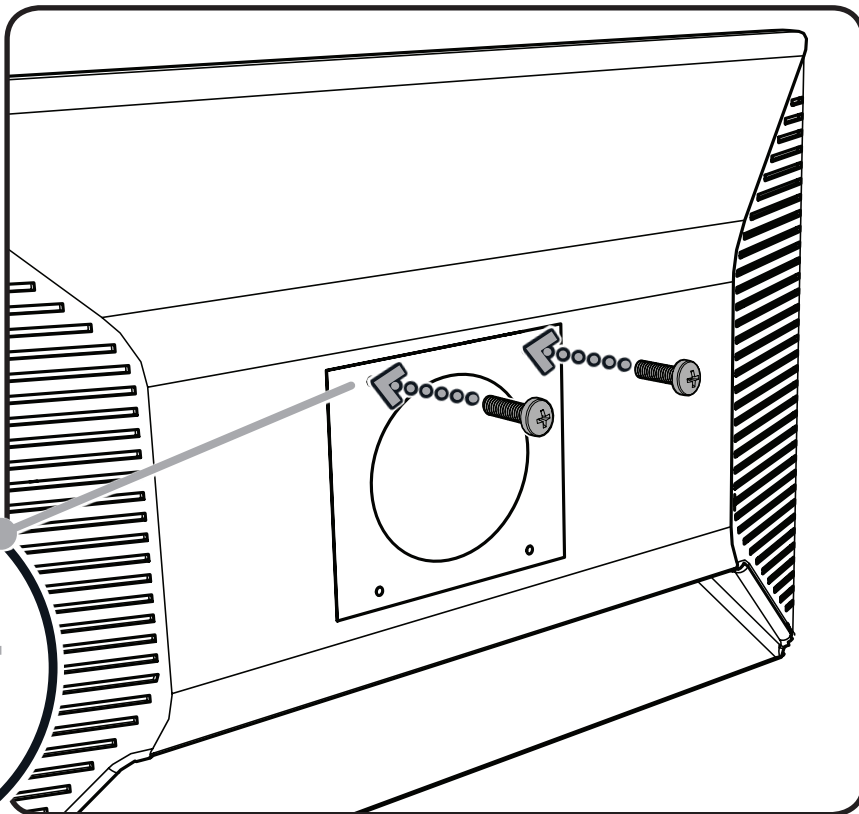
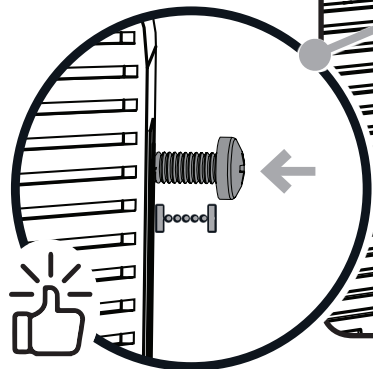
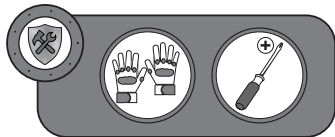
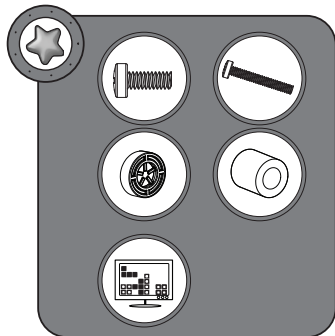

OR

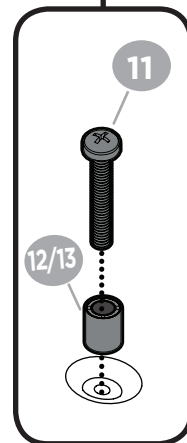



STAGE 3: Hang Monitor by Top Screws onto Bracket

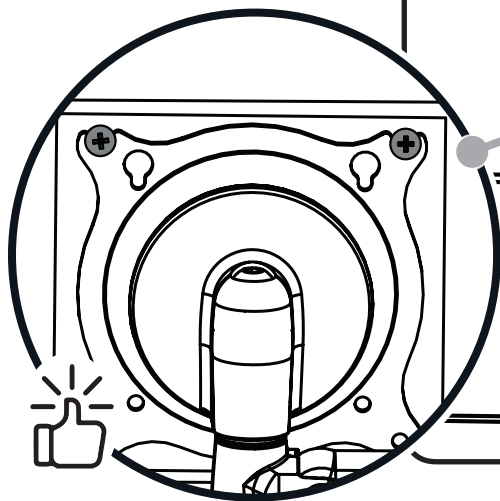
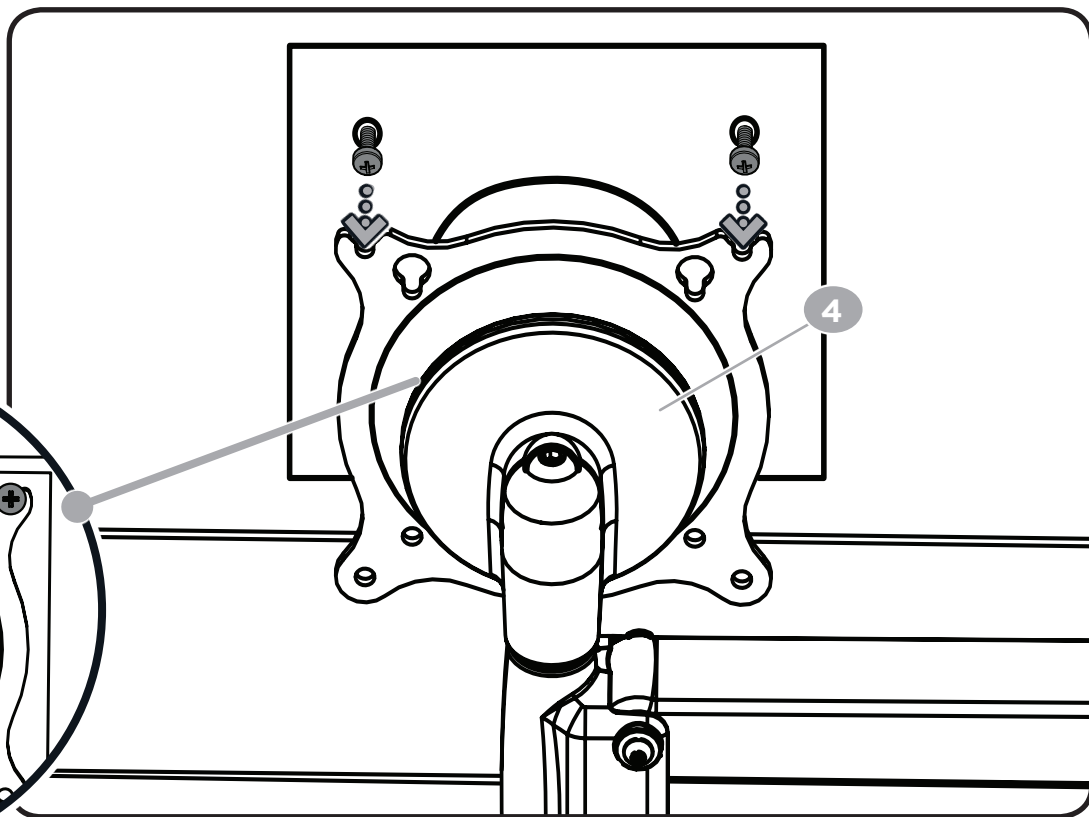
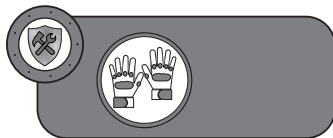
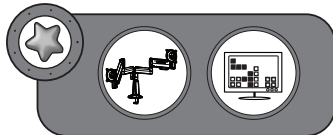



STAGE 4: Partially Insert Bottom Screws

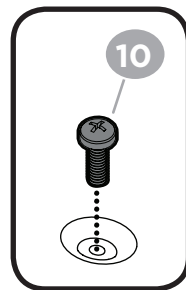
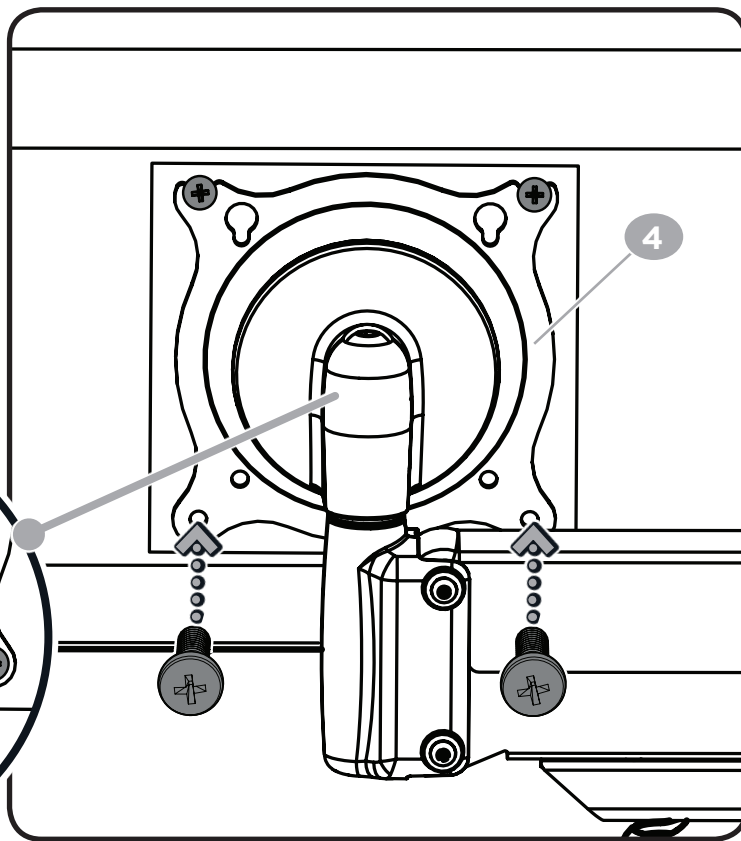
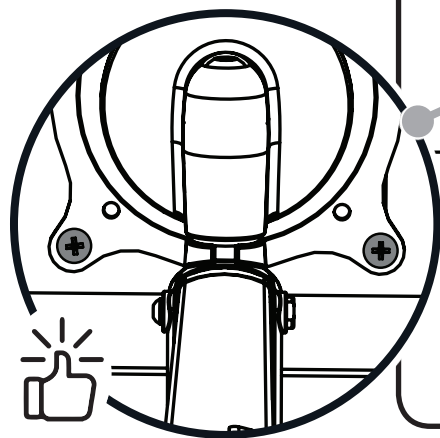
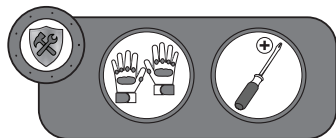
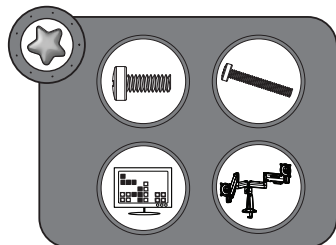

OR

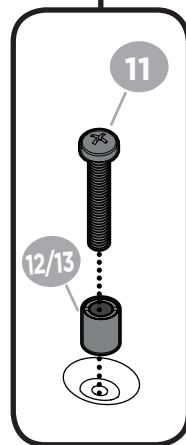



STAGE 5: Test and Tighten All Screws to Secure Monitor

IMPORTANT: YOU SHOULD TEST THE TENSION OF THE ROTATING BRACKET ^(R) TO ASSURE THE MONITOR MOVES WITH EASE AND STAYS IN POSITION BEFORE TIGHTENING ALL SCREWS. See page 20 to adjust bracket tension.

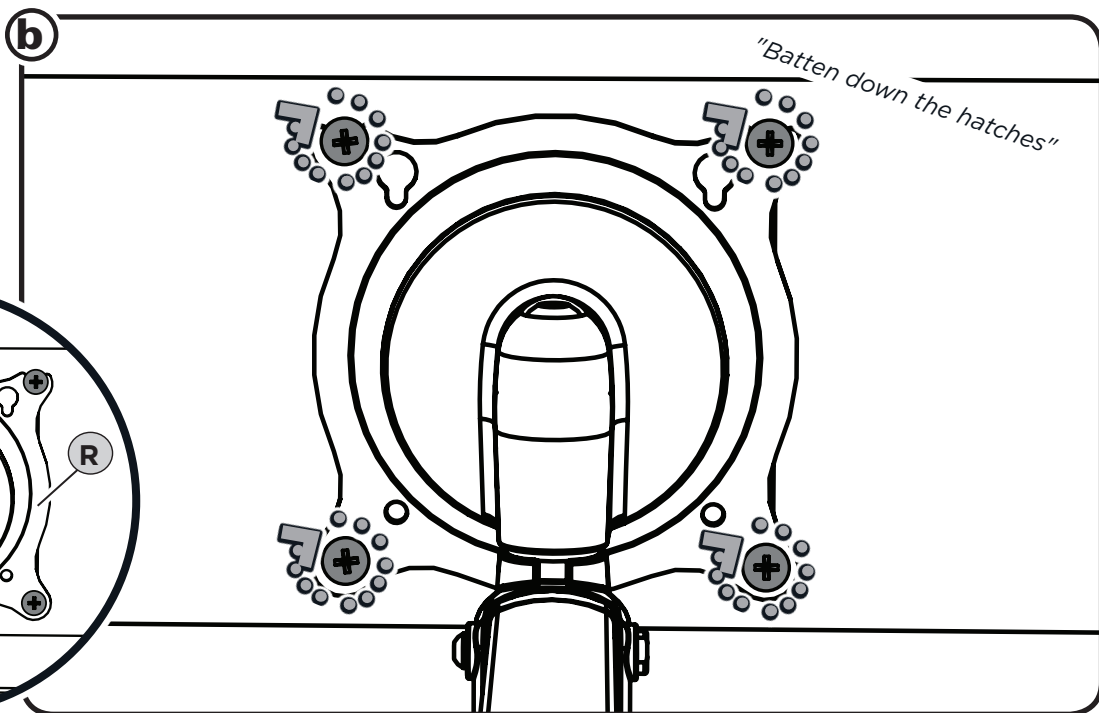
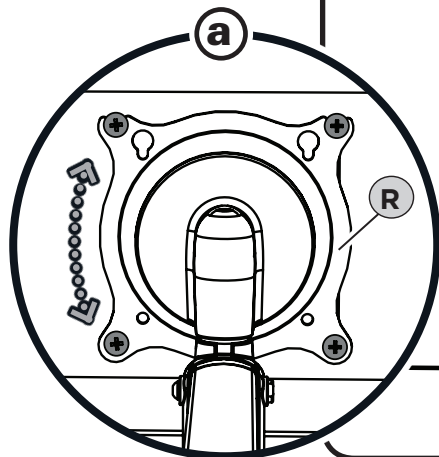
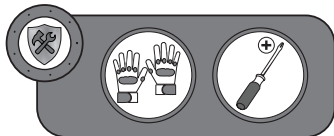
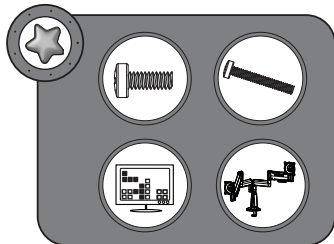



STAGE 6: Repeat Level 2 Again to Complete Mission

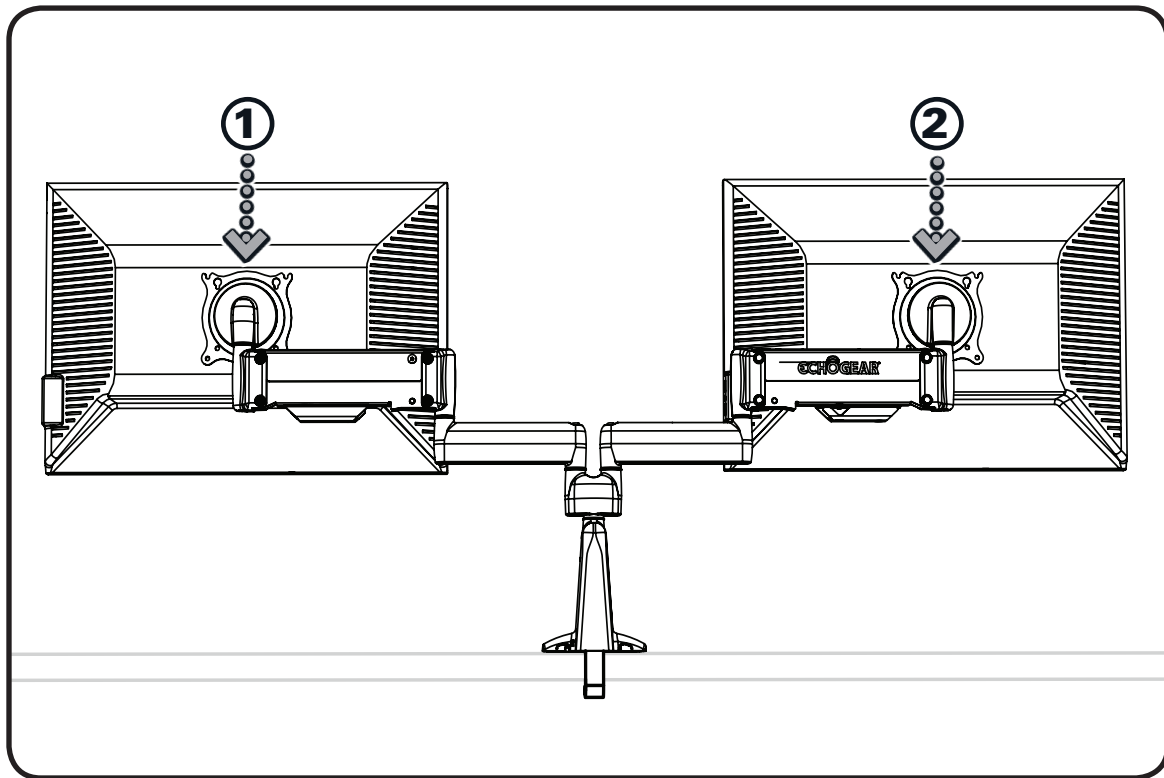
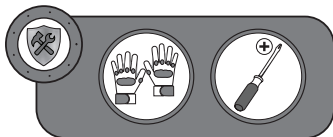
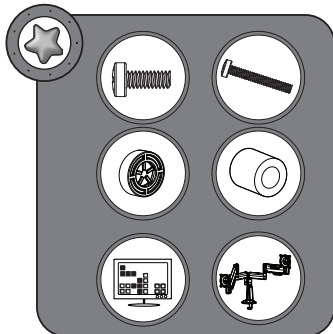

LEVEL 3 CONTROL THE MELEE! ROUTE AND DISGUISE CABLES



STAGE 1: Route All Cables Through Brackets

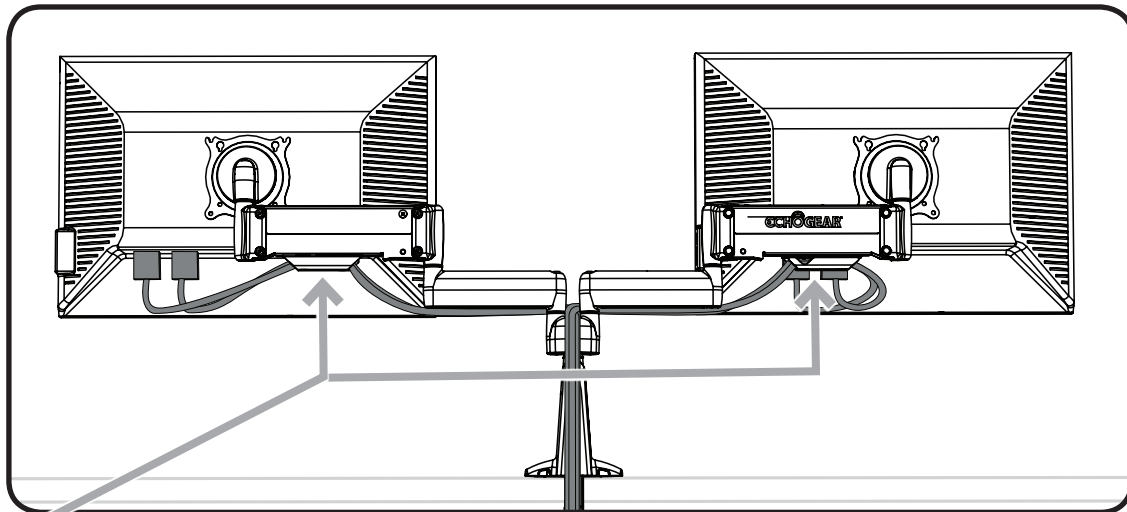
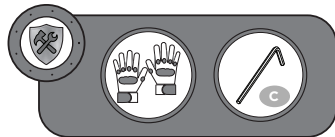

NOTE: FOR THICKER CABLES USE HEX KEY **C** TO LOOSEN SCREWS **S** ON ARM BRACKET AND SLIDE BRACKET OUT.

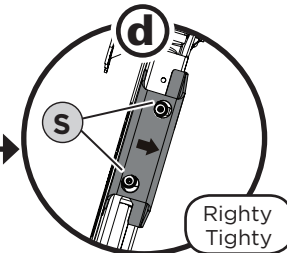
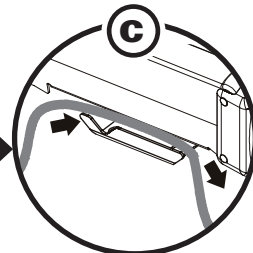
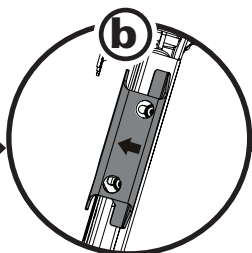
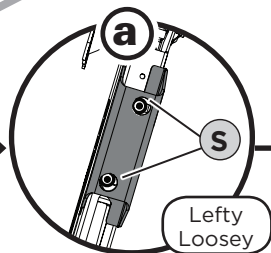

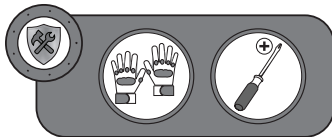
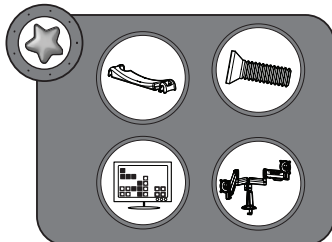

STAGE 2: Secure Cables with Arm Cover⁺²

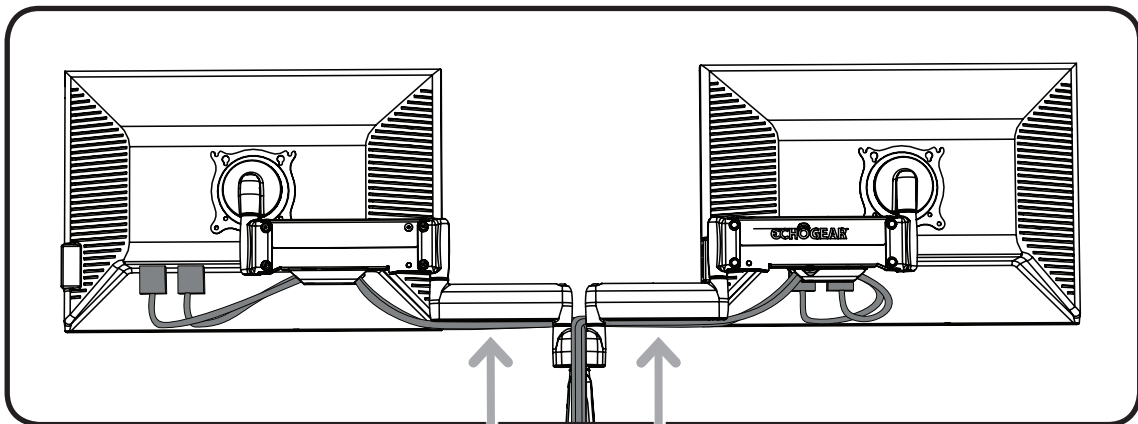

"Make the proper adjustments. Then it's adjustment time to post some pics of your battlestation. Don't forget to add: #YourGearUpgraded"

IMPORTANT:
LEAVE ENOUGH
SLACK IN THE
CABLES TO
ASSURE THE
MONITOR AND
ARMS MOVE
WITH EASE.

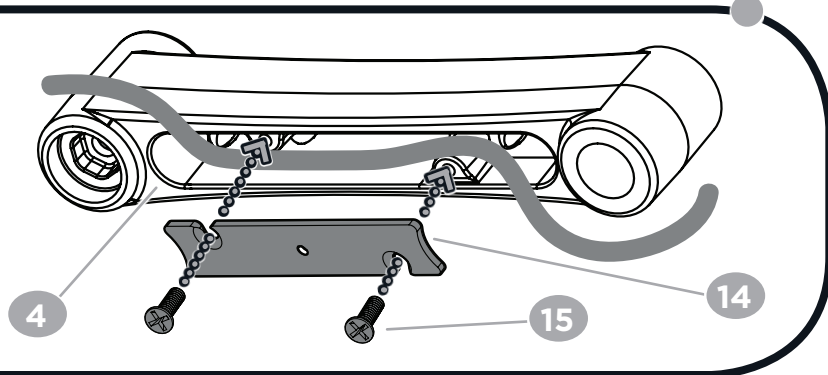

BONUS LEVEL! ADJUSTMENTS /MODIFIERS



Vertical Position - Adjust Monitor Up and Down

TIP: INITIALLY, NEARLY ALL MONITORS WILL REQUIRE POSITIVE ADJUSTMENT (UP TO 20 TIMES). IF THE MONITOR IS NOT STAYING AT DESIRED HEIGHT OR NOT MOVING WITH EASE:

- ADJUST TENSION SCREW ON THE TOP OF THE MOUNT.
- START BY TURNING 5 OR 6 TURNS, **+** = **MORE TENSION** OR **-** = **LESS TENSION**.
- REPEAT TURNS UNTIL DESIRED TENSION IS ACHIEVED.

NOTE: YOU MAY NEED TO ADJUST HEIGHT OF ARM TO GAIN ACCESS TO SCREW.

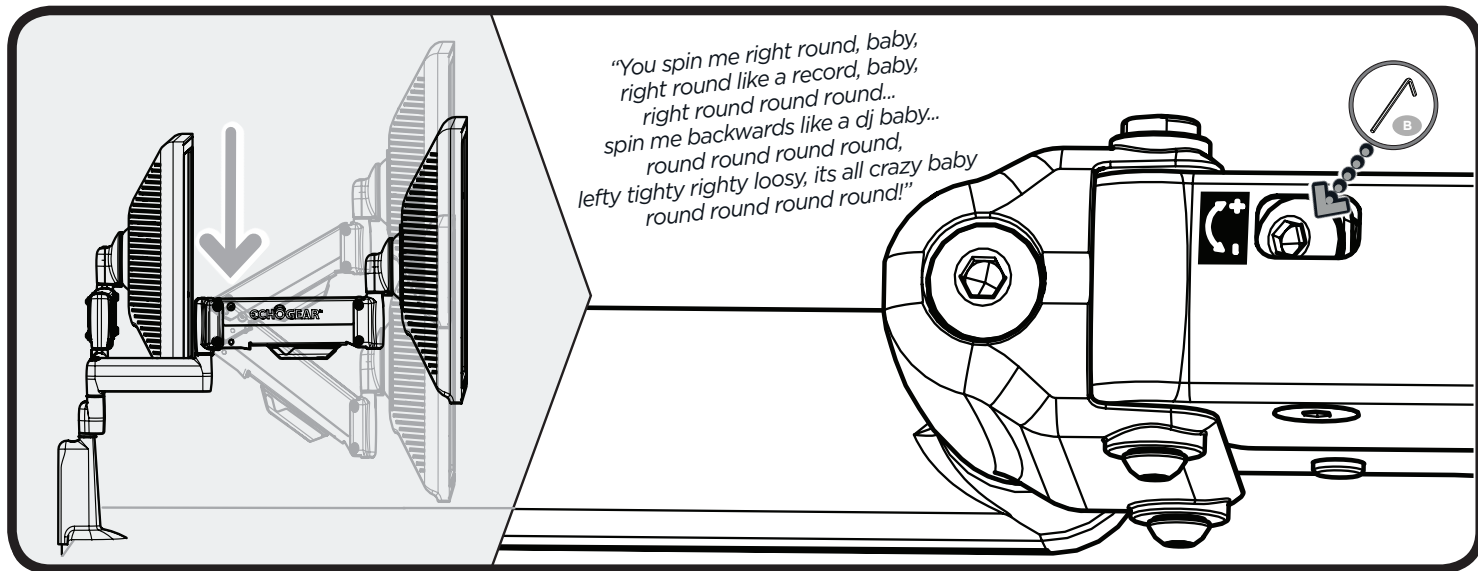



Tilt &

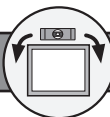

Level - Tilt and Turn Monitor 360°

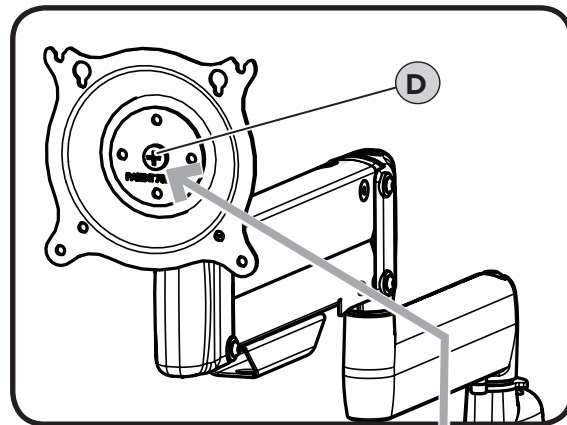
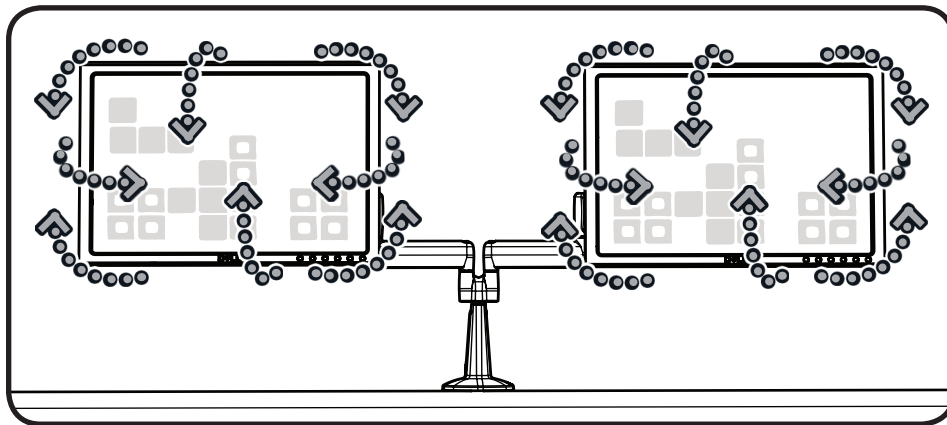

"Come on ...
level with me..."



WARNING: MONITOR MUST REMAIN OVER DESK SURFACE.

IF MONITOR DOES NOT MOVE WITH EASE OR WILL NOT LOCK INTO DESIRED POSITION:

Remove the monitor. Turn the screw **D** on the tension bracket either counter-clockwise (loosen) or clockwise (tighten) **D**. Repeat as needed.



Horizontal Position - Adjust Monitor Left or Right

⚠ WARNING: MONITOR MUST REMAIN OVER DESK SURFACE.

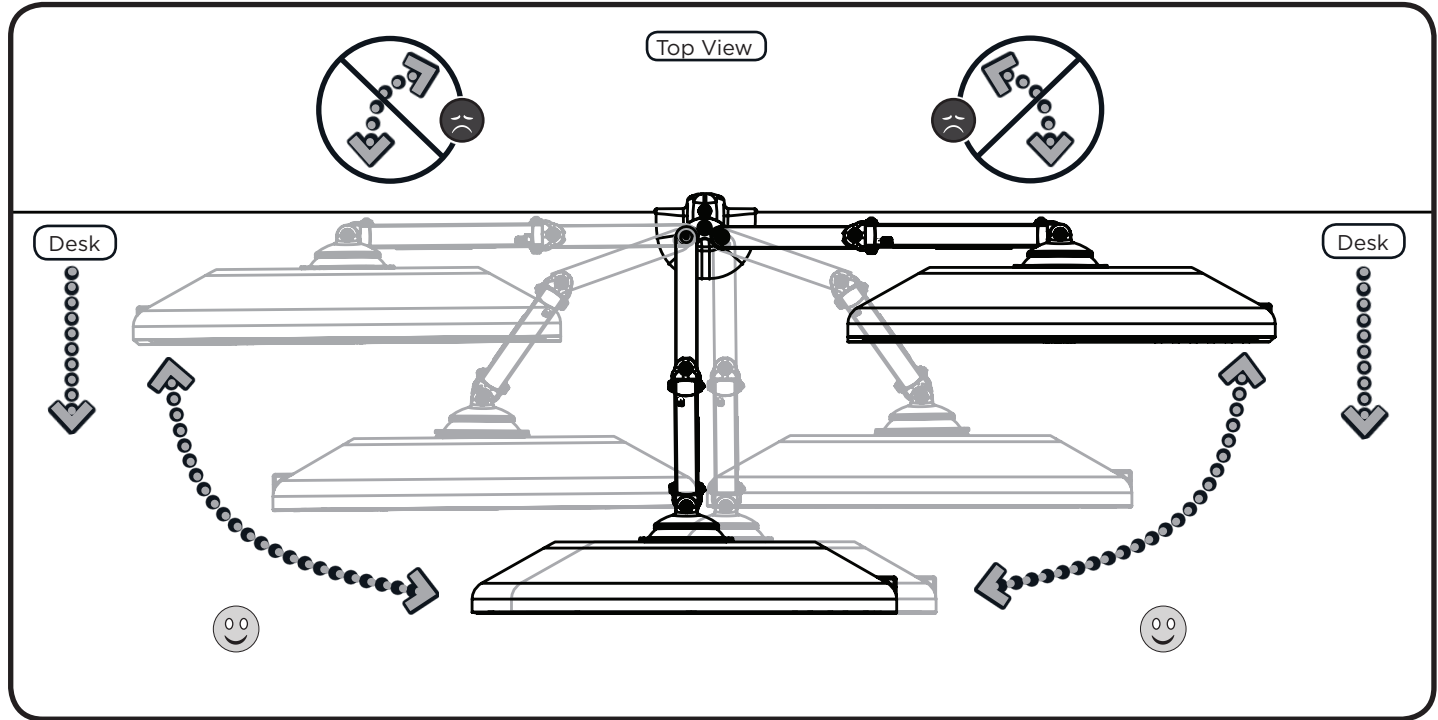

HOW TO REMOVE MOUNT FROM MONITOR AND SURFACE

1. Remove Cables
2. Remove Monitors
3. Remove Arms/Mount

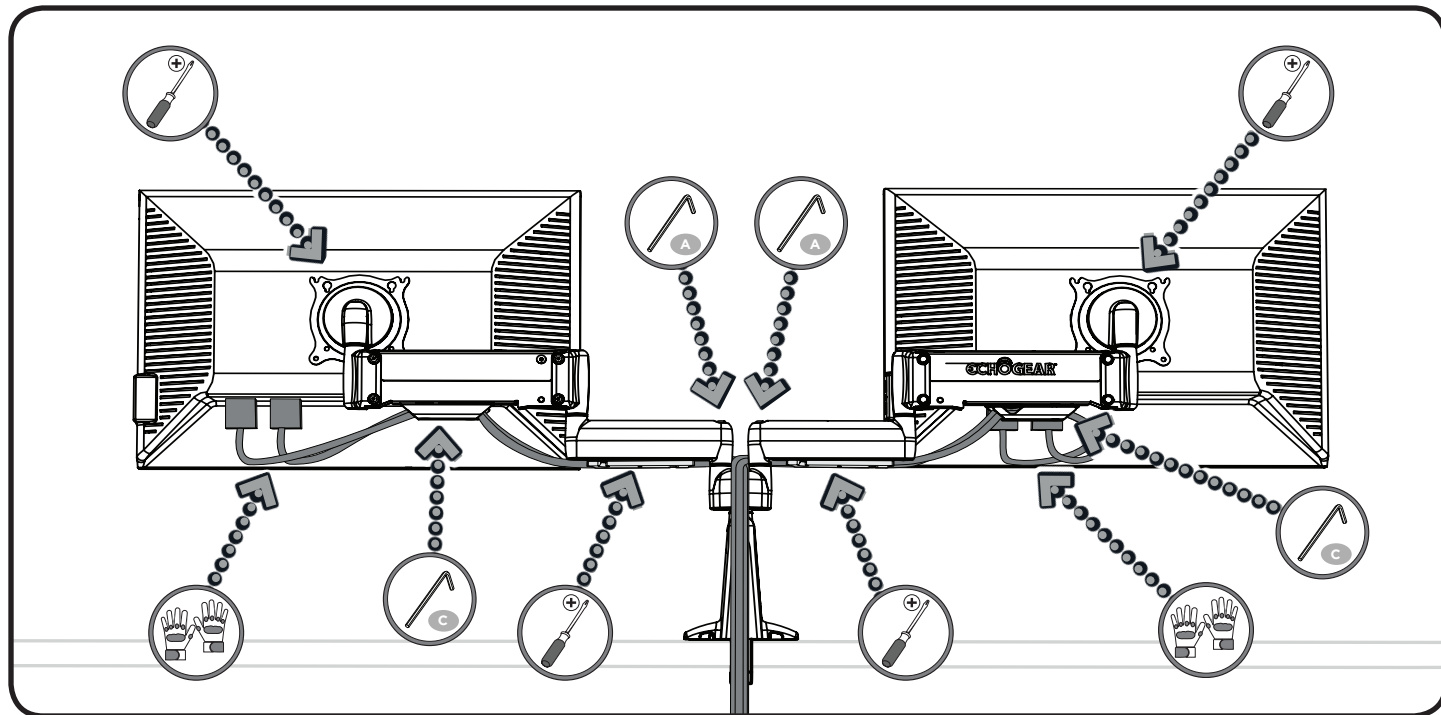



"Wanna show off your skillzz?
Share a picture of your completed mount
with **#YourGearUpgraded**.
Who knows, it might not be as bad as you thought"

***Confuzzled?* Contact the ECHOGEAR Pros:**



1-855-428-2490



helpmehelpyou@ECHOGEAR.com



ECHOGEAR.com

Milestone AV Technologies and its affiliated corporations and subsidiaries (collectively, "Milestone"), intend to make this manual accurate and complete. However, Milestone makes no claim that the information contained herein covers all details, conditions, or variations. Nor does it provide for every possible contingency in connection with the installation or use of this product. The information contained in this document is subject to change without notice or obligation of any kind. Milestone makes no representation of warranty, expressed or implied, regarding the information contained herein. Milestone assumes no responsibility for accuracy, completeness or sufficiency of the information contained in this document.

©2018 Milestone AV Technologies. All rights reserved. ECHOGEAR is a Milestone brand.

ECHOGEAR and the ECHOGEAR logo are trademarks of Milestone.

Made in China.

Milestone Global Headquarters • 6436 City West Parkway • Eden Prairie, MN 55344 USA

6901-602312 00